

P e l l F r i s c h m a n n

Enviroparks Site Supervision

Revised Temporary Wildlife Protection Area - Completion of Mitigation Works

Date: October 2016

excellence through innovation

This report is to be regarded as confidential to our Client and is intended for their use only and may not be assigned. Consequently, and in accordance with current practice, any liability to any third party in respect of the whole or any part of its contents is hereby expressly excluded. Before the report or any part of it is reproduced or referred to in any document, circular or statement and before its contents or the contents of any part of it are disclosed orally to any third party, our written approval as to the form and context of such a publication or disclosure must be obtained.

Prepared for:

Mark Bollington Esq
Enviroparks (Wales) Limited
Registered No. 07034699
1st Floor Tiverton Place
Lion Street
Abergavenny
NP7 5PN

Prepared by:

Pell Frischmann
Burrator House
Peninsula Park
Rydon Lane
Exeter
EX2 7NT

Contents

1	Introduction	1
2	Mitigation Works for the Temporary Wildlife Protection Area at Envioparks Hirwaun	2
3	Reptile Fencing.....	3
4	Conclusion.....	6

Appendices

Appendix A – Contractors Report

Appendix B – Revised Wildlife Protection Areas

1 Introduction

A Wildlife Protection Plan (April 2015, Ref: R57006005/F) was submitted and agreed with Brecon Beacons National Park Authority (BBNPA) and Rhondda Cyon Taf (RCT) as part of a formal discharge of pre-commencement conditions attached to planning permission numbers 08/02488/FUL (BBNPA) and 08/1735/10 (RCT) at Envioparks, Hirwaun.

A Temporary Wildlife Protection Area (TWPA) within the Envioparks site was agreed with BBNPA and RCT as set out in the approved Wildlife Protection Plan. During the construction of the Phase 1 development, there was an encroachment into the TWPA which affected approximately 0.5ha of part of the TWPA.

A meeting was held with BBNPA's ecologist and enforcement officer in August 2016 to agree an appropriate revised TWPA and related mitigation works. Following the meeting with Bridgit Symons and Lisa Hughes of BBNPA, ecological mitigation works were agreed to be undertaken within the TWPA. The aim of the works is to optimise the suitability of the TWPA habitat for reptiles and included:

- Grass seed collection on site
- Seeding over spoil and hard standing areas
- Re-location of sections of reptile fencing

Details of the works completed to date are outlined within this report.

2 Mitigation Works for the Temporary Wildlife Protection Area at Envioparks Hirwaun

The grass seeding work was completed in August 2016. A full report from the contractor is attached in Appendix A.

The site was prepared prior to seeding. The area of hard-core west of the car park was found to have been placed over a porous geofabric. The decision was made that, rather than removing this material, it should be left in situ and not disturbed. A small amount of subsoil was therefore moved from the adjacent bund and spread over the surface of the hard-core to create a suitable seed bed for the grass/wildflower seed.

Grass/wildflower seed was collected from the northern end of the site using a flail mower and specialist collector. The area mown is shown as '*Area for Grass Cutting*' on drawing D57006V104 C (attached in Appendix B).

Seed was spread over both the covered hard core and the bund areas (as shown in Appendix B).

Grass seed had germinated during September (see Plate 1 below). Wild flower seed will germinate next spring.

Plate 1: Grass seeded area germination (28.09.2016)



3 Reptile Fencing

The reptile fencing was installed on the 26-28th September 2016

The ground conditions were poor, with waterlogged soils, especially in the south east corner by the end of the bund.

The south west section of the existing reptile fence was repaired and a new section erected to connect the fence through to the stream next to the concrete culvert. Bramble growth was cut back along this section to protect the fence.

The new reptile fence was erected as shown on the Temporary Wildlife Protection Area Plan D57006V104 C (attached in Appendix B).

In the north east of the site a strip has been cut through the willow scrub to enable the fence to be erected through to the Dwr Cymru Site.

The reptile fence requires the addition of Heras fencing to provide protection during construction works. The heras fencing will be erected and checked by the project ecologist prior to the commencement of the Phase 2 works.

The area seeded with cut grass on site is germinating well – see photographs below. To date there is good grass germination, but little sign of other wildflowers, many of which will be dormant until spring.

Plate 2: Reptile fence (north eastern end)



Plate 3: Reptile fence through woodland



Plate 4: Reptile fence across level area, by car park



Plate 5: Reptile fence along roadside



Plate 6: New section of fence (south western end)



4 Conclusion

Mitigation measures, as agreed with officers at BBNPA at an on-site meeting have been carried out and completed at the site.

The integrity of the TWPA has been restored, although a section of the TWPA has been lost due to hard standing and portable buildings.

The revised TWPA as detailed in this report will now be retained and maintained as detailed and set out in the approved WPP (April 2015).

Appendix A – Contractors Report

Enviroparks Hirwaun Grass seeding August 2016

Ground breaking and Soil Spreading

It quickly became apparent after four trial holes, that the area for subsoil breaking, was in fact stone laid on a terram sheeting, to a depth of 300-400mm. The drainage was similar to natural ground conditions, which has a high water table and standing water in hollows, and a very clay soil, with regular round boulders in. This is known from previous fencing work on site, with included trenching for the earlier reptile fence.

We therefore spoke to Simon Humphreys, advising leaving the stone in place, but overlaying with soil taken from the bund. This was agreed. A dumper was hired in to help achieve this, and the digger was reallocated to a full day on this, rather than 2 hours ground breaking and then trenching for the reptile fence.

A small amount only of ground breaking was undertaken. Subsoil from the bund was spread to a depth of circa 100mm, left quite rough, in part to the very claggy clay soil, in part due to boulders in the mix and in part due to the purpose of creating reptile habitat.

The spoil pile was regraded and contoured after excavation. It contained a wide range of material including concrete, plastic and original soils from the site. Most of the plastic etc was reburied within the mound. Some was hand-picked from the graded area for reseeding, and either taken from site or added back to the bund for burying. Some rubbish from the general area was stacked and left adjacent to a container on site.

Seed spreading

This went smoothly, with grass seed collected from the allocated area, by means of a specialist flail mower and collector. Because of the delays in the preparation of the receptor site the mowing were stacked at different locations around the receptor site and later spread by hand, rather than the planned small muckspreader. This made little difference to the work schedule.

Other

Easy site access, with security guard expecting us.

I was present on site from 7.30am to 6.30pm. Plant hire company were on site 8am to 6pm. Grass mowing team were on site 12noon to 3.30pm. Due to the late finish, plant hire is being collected today (25th August).

An Enviroparks project manager was apparently on site briefly, speaking to the security guard, but did not come to speak to us.

Photographs



Before



Soil being taken from bund



Subsoil being spread



Piles of subsoil to be spread



Spreading spoil with seed spread foreground



Flail mower seed collection



Mown area



Completed job

**Stephen Lees
Wildlife Woodlands
25th August 2016**

Appendix B – Revised Temporary Wildlife Protection Area

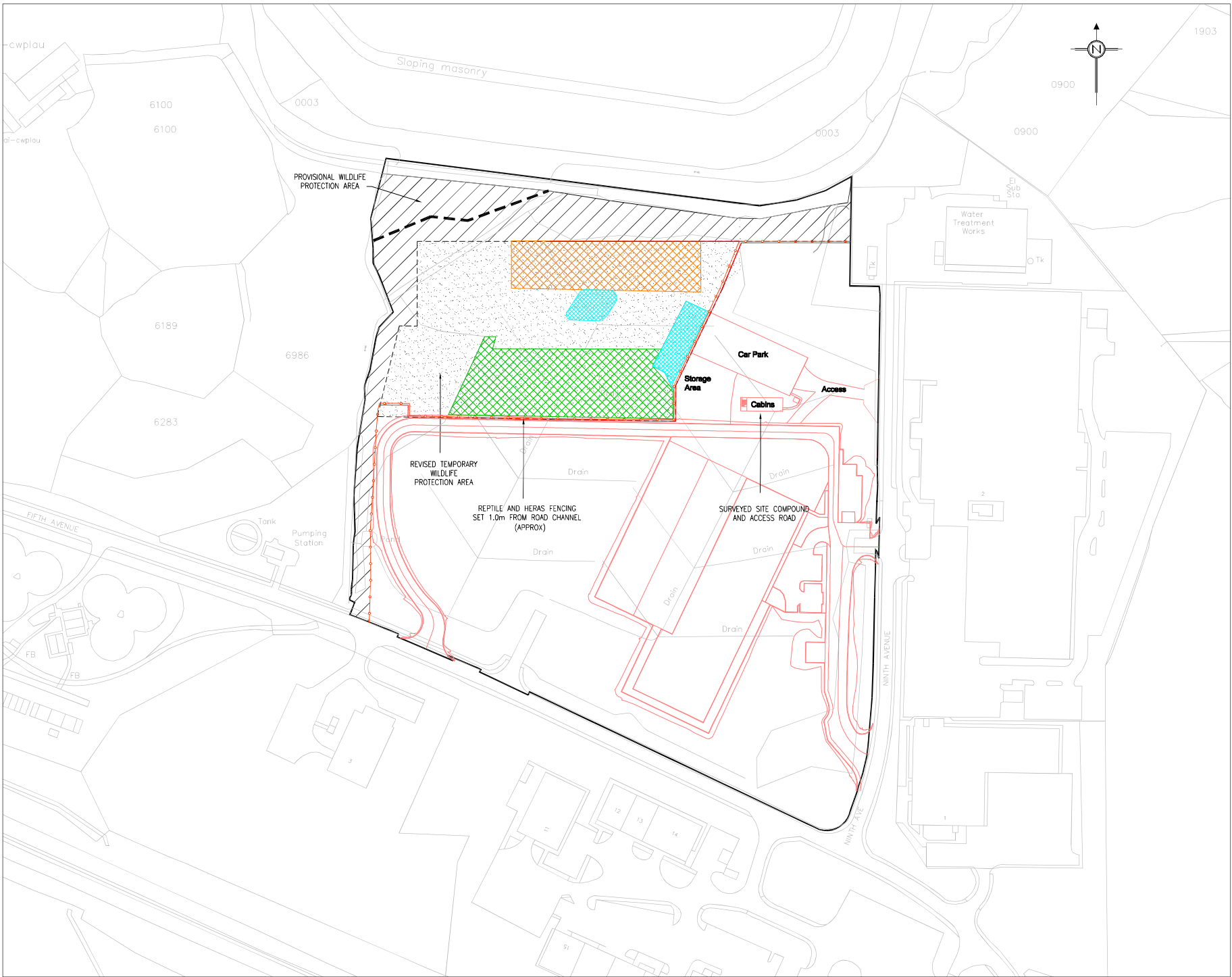

LOCATION PLAN
SCALE 1:1000

1. This drawing should only be relied upon by the copyright holder. Pell Frischmann will not accept liability if this drawing is used for any purpose other than that for which it has been prepared.
2. Where this is an on-call drawing, it shall be based on Pell Frischmann's consultation drawings with all changes accepted and checked by the contractor. Pell Frischmann is in no way responsible for the accuracy of the information supplied by the contractor nor for any losses incurred by changes made on site.
© Pell Frischmann

NOTES:
1. THIS DRAWING IS A REVISION OF DRAWING D57006V003.

- KEY:**
- SITE BOUNDARY
 - PROVISIONAL WILDLIFE PROTECTION AREA
 - REVISED TEMPORARY WILDLIFE PROTECTION AREA
 - STREAM RE-ALIGNMENT
 - HERAS FENCE (TO BE ERECTED PRIOR TO PHASE 2 COMMENCEMENT)
 - REPTILE FENCE
 - AREA FOR GRASS CUTTING
 - AREA FOR SEEDING (BUND AREA)
 - AREA FOR SEEDING (FORMER HARDCORE)

D	AMENDMENTS TO NOTES	PND	STH	CMG	STH	05.10.16
C	MINOR AMENDMENTS	PND	STH	CMG	STH	03.10.16
B	CLIENTS COMMENTS	RE	RE	CG	SK	11.07.16
A	INITIAL ISSUE	RE	RE	CG	SK	04.07.16

Pell Frischmann
PENINSULA PARK RYDON LANE EXETER EX2 7NT
Tel: +44(0) 1392 444345 Fax: +44(0) 1392 444880
Email: pfrischm@pellfrischmann.com
www.pellfrischmann.com

P.F. Project No: E57006
Client:
enviroparks
reuse, recycle & recover

Client Project No: --
Client Project Title: --
Project:

HIRWAUN ENVIROPARKS

Drawing Title:
REVISED WILDLIFE PROTECTION AREAS

	Name	Date	Scale	1:1000	Size	A1
Drawn	PND	05.10.16				
Designed	STH	05.10.16	File No.	D57006V104.dwg		
Checked	CMG	05.10.16	Drawing Status	PLANNING		
Approved	STH	05.10.16				
Drawing No.	D57006V104					Revision
						D

This page has been left intentionally Blank